

ROTARY LOBE PUMP



Revolution[®]

Increase your expectations!



wright flow
TECHNOLOGIES[®]

Capacity to 76 m³/hr / 333 USGPM

Pressure to 15 BAR / 218 PSI

Viscosity to 440,000 cSt / 2,000,000 SSU

Temperature to 150°C / 300°F

HYGIENIC PUMP SOLUTIONS

IDEX
FLUID & METERING

**YOUR COMPLETE
Hygienic Solutions Provider**

- GLOBAL PRESENCE WITH LOCALIZED SERVICE
- BROADEST PD PUMP OFFERING IN THE INDUSTRY
- COMPLETE PARTNER FOR YOUR HYGIENIC PROCESS



Around the world, Wright Flow Technologies provides solutions for challenges in fluid handling. You can count on the reliability of Wright Flow hygienic positive displacement (PD) pumps. Matching the right pump with your fluid processing needs is easy with innovative, robust designs, cleanability & an extensive product offering.

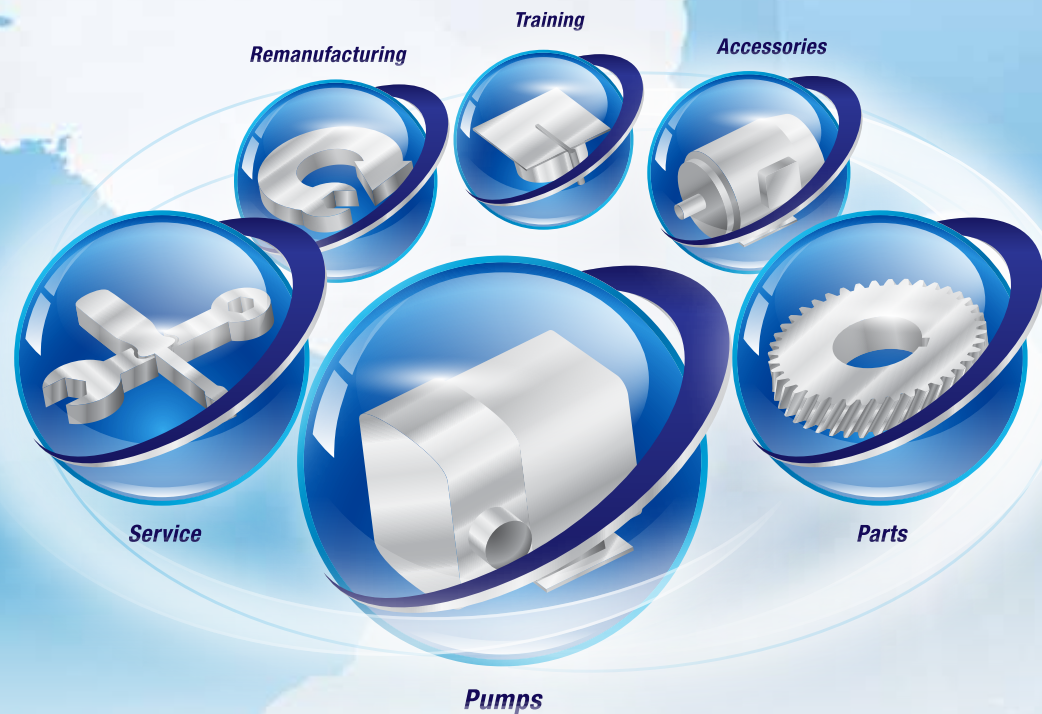

Revolution[®]
Increase your expectations!

Raise the bar on performance & ease of maintenance with the Revolution. Revolution is the most advanced circumferential piston pump in the industry with front loading seals. Also, it is the only pump available with patented hybrid technology, allowing CPP or RLP technologies.



How it Works

Suction

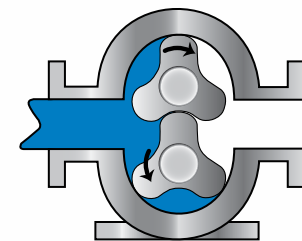

Wright Flow Technologies rotor lobes (pistons) rotate around the circumference of the channel in the pump casing. This continuously generates a partial vacuum at the suction port as the rotors unmesh, causing fluid to enter the pump.

Discharge

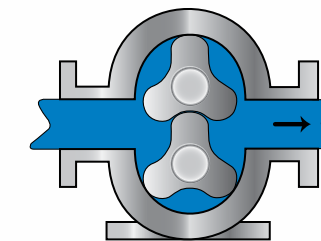

The fluid is transported around the channel by the rotor lobes, and is displaced as the rotor lobes re-mesh, generating pressure at the discharge port. Pump output is directly proportional to speed, and direction of flow is reversible.

CHEMICAL
Raw Ingredients, Chemical Transfer, Solvent Recovery

PERSONAL CARE
Skin Care Products, Toothpastes, Cosmetics, Shower & Shaving Liquids, Hair Care Products

BEVERAGES
Distillers & Vinters, Fruit & Vegetable Purees, Carbonated Drinks, Juices

FOOD
Baby Food, Edible Oils, Soft Fruits & Vegetables, Soups & Sauces, Egg, Fish, Meat, Poultry, Whey Proteins, Confectionary

DAIRY
Butter, Cheese, Cream, Milk, Yogurt, Yogurt Fruits

BIO PHARMACEUTICAL
Creams & Ointments, Ferment, Injectables, Ultra Filtration, Blood & Plasma Processing

Revolution®

The Revolution is the first hybrid rotary lobe & circumferential piston pump with front loading seals. See for yourself how we raised the bar on performance & redefined ease of maintenance for our industry.

EASE OF MAINTENANCE

- Fast, front loading seal changes while pump is still in-line
- Easy access shimming for setting rotor clearance
- Heavy duty shafts give up to 50% longer life, reducing maintenance and lost production time
- 100% of gearbox components are identical for all combinations within a gearbox size and pump principle, giving lower spares stock handling and greater interchangeability

PERFORMANCE

- Improved volumetric efficiency in low & high viscosity applications
- Innovative rotor design reduces shear & pulsation effect
- Long-life durability from heavy duty shafts & gearcase

CLEANABILITY

- Efficient CIP (Clean In Place) ability is standard for all Revolution pumps
- Enhanced front cover design eliminates dead zones
- Stainless steel bearing retainers & foot*

*Stainless bearing retainers & foot available as standard on models 150-1300.

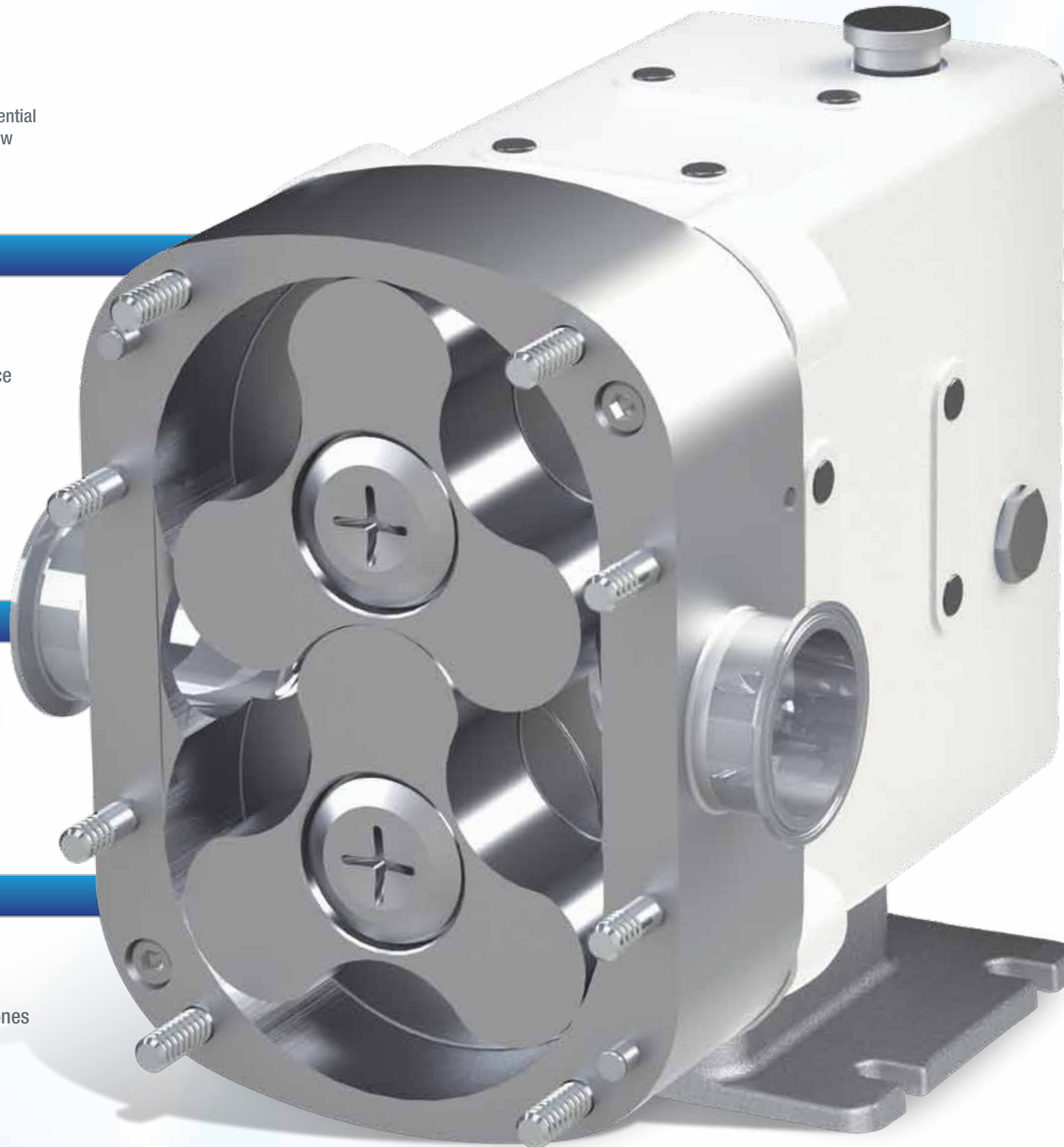

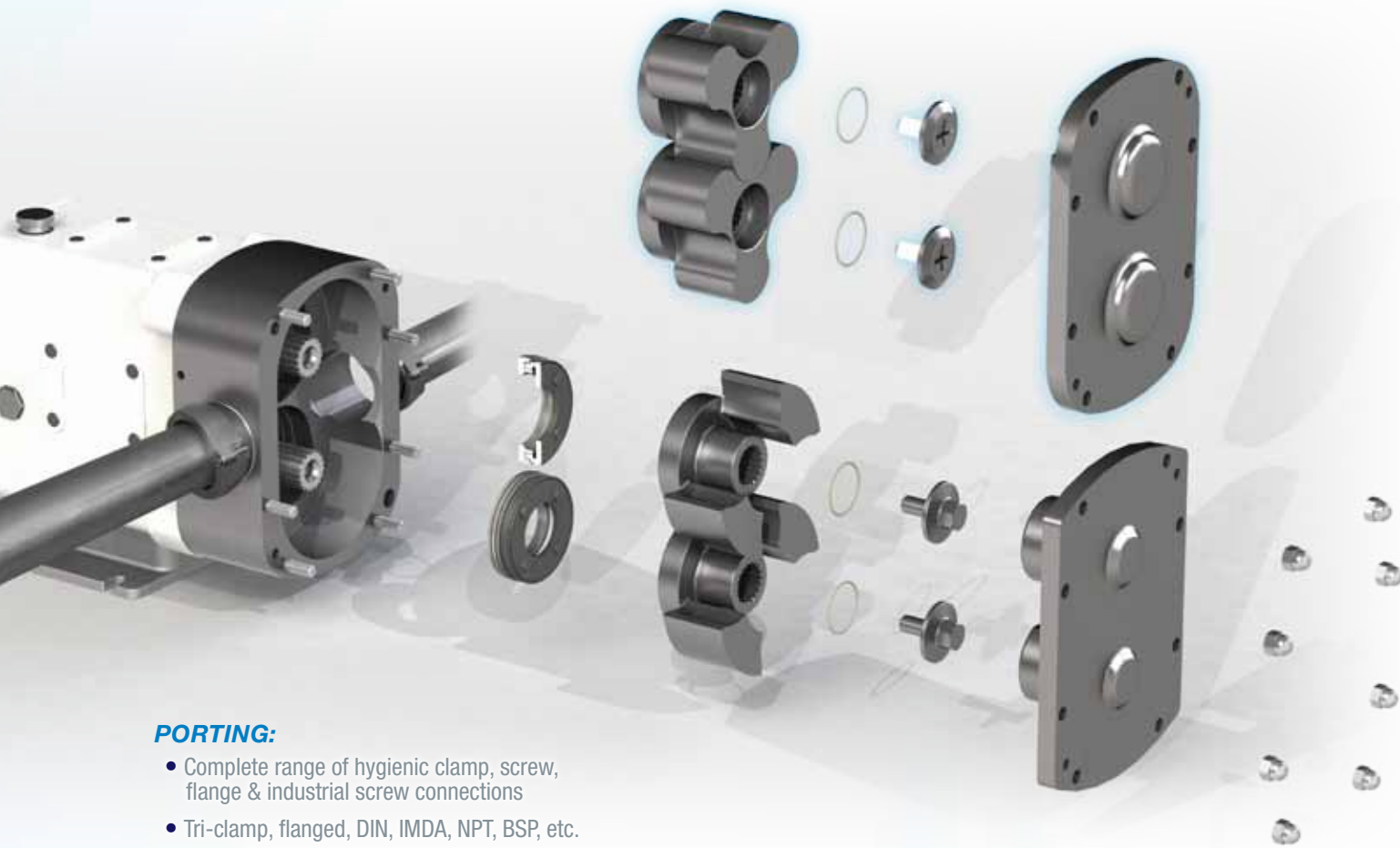

PORTING:

- Complete range of hygienic clamp, screw, flange & industrial screw connections
- Tri-clamp, flanged, DIN, IMDA, NPT, BSP, etc.
- Range of enlarged / hopper inlets

SEALS:

- Single O-ring (frame sizes 2-5)
- Double O-ring w/ flush (frame sizes 2-5)
- Single mechanical
- Double mechanical w/ flush
- Complete range of material options

GEAR BOX:

- Powder-coated or painted standard (size dependent)
- Gamma seal protection for gear box oil seals standard
- Stainless steel optional

ROTOR & CASING:

- 316L stainless steel pump casing w/ interior finished to 3-A standards
- 316L stainless steel rotors
- Improved surface finishes & electropolishing optional

ROTOR CASE INTERNAL SURFACE FINISH:

- 0.8 µm (32 µin) standard
- internal finishes:m/c to 0.6µm (24 µin)
- Mech. polish to 0.5µm (20 µin) or better

HEATING & COOLING:

- 3.5 Bar operating pressure
- -20°C (-4°F) to +150°C (300°F)
- All pumps may be fitted with front cover and rotor case jackets when required

ROOM TEMPERATURE RATING:

- 90°C (200°F), 150°C (300°F)

Complete offering of coatings, finishes, materials & options available upon request.

PERFORMANCE RANGE:

- CAPACITY** to 76 m³/hr / 333 USGPM
- PRESSURE** to 15 BAR / 218 PSI
- VISCOSITY** to 440,000 cSt / 2,000,000 SSU
- TEMPERATURE** to 150°C / 300°F

COMPLIANT WITH THE FOLLOWING STANDARDS



Size	Revolution RLP Model	Displacement		Max Pressure		Max Speed	Standard Ports		Max Capacity		Max Temperature	
		l/rev.	USG/rev.	BAR	PSI	RPM	mm	in.	m ³ /hr	USGPM	Deg. C	Deg. F
2	R0150X	0.061	0.016	15	218	1000	38.1	1.5	3.6	16	150°	300°
	R0160L	0.081	0.021	10	145	1000	38.1	1.5	4.9	22	150°	300°
	R0180L	0.11	0.029	7	102	1000	38.1	1.5	6.6	29	150°	300°
3	R0200X	0.18	0.05	14	203	1000	38.1	1.5	11	47	150°	300°
	R0300X	0.25	0.07	9	131	1000	38.1	1.5	15	66	150°	300°
	R0400X	0.33	0.09	7	102	1000	50.8	2	20	86	150°	300°
4	R0450X	0.45	0.1	15	218	800	50.8	2	22	95	150°	300°
	R0800X	0.82	0.2	9	131	800	63.5	2.5	39	173	150°	300°
	R1300X	1.07	0.3	7	102	800	76.2	3	51	226	150°	300°
5	R1800X	1.55	0.4	15	218	600	76.2	3	56	246	150°	300°
	R2200X	2.1	0.6	8	116	600	101.6	4	76	333	150°	300°

Preventive Maintenance Kits

ENSURE TROUBLE-FREE OPERATION & SUPERIOR PERFORMANCE

Benefits of Maintenance Kits:

- Everything you need in one place
- Reduce frequency of repairs
- Increase service life
- Increase uptime
- Save time & money
- Kits include exploded diagram & parts list



Revolution[®]

Increase your expectations!



- Ease of Maintenance
- Exceptional Cleanability
- Long Life Durability



FRAME 2
1.5 in.
(38.1 mm)

FRAME 3
1.5 or 2 in.
(38.1 or 50.8 mm)

FRAME 4
2, 2.5 or 3 in.
(50.8, 63.5 or 76.2 mm)

FRAME 5
3 or 4 in.
(76.2 or 101.6 mm)

FRAME 6
6 in. (152.4 mm)
CPP ONLY

FRAME 7
6 or 8 in. (152.4 or 203.2 mm)
CPP ONLY

wright flow
TECHNOLOGIES[®]

WRIGHT FLOW TECHNOLOGIES, INC.
406 State Street
Cedar Falls, IA 50613 USA
Phone: (319) 268-8013 • E-mail: wright.usa@idexcorp.com

WRIGHT FLOW TECHNOLOGIES LTD.
Highfield Industrial Estate, Edison Road Eastbourne
East Sussex, United Kingdom, BN23 6PT
Phone: +44(0) 1323 509211 • E-mail: wright.eu@idexcorp.com

WRIGHT FLOW TECHNOLOGIES SUZHOU
Block 6, No.428 Xing Long Street
Su Chun Industrial Square, Suzhou Industrial Park
Suzhou 215126, China
Phone: (0512) 62833000*333

FOR MORE INFORMATION, CONTACT YOUR LOCAL AUTHORIZED
WRIGHT FLOW TECHNOLOGIES DISTRIBUTOR OR CONTACT US AT:

Distributed By:

WRIGHTFLOWTECHNOLOGIES.COM

